

**CONCRETE PATH TYPICAL SECTION – TYPE 1**  
SCALE 1:20 (A1)

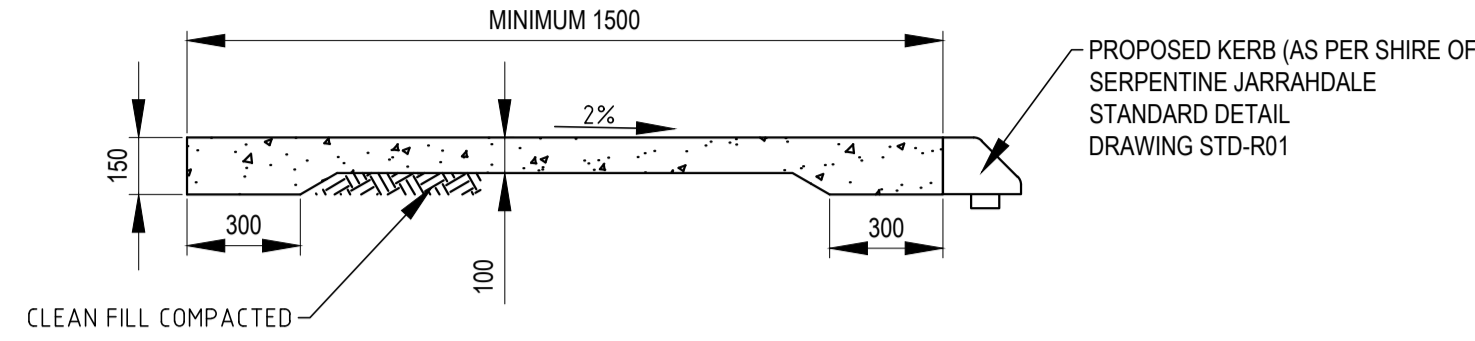

**CONCRETE PATH TYPICAL SECTION – TYPE 2**  
SCALE 1:20 (A1)

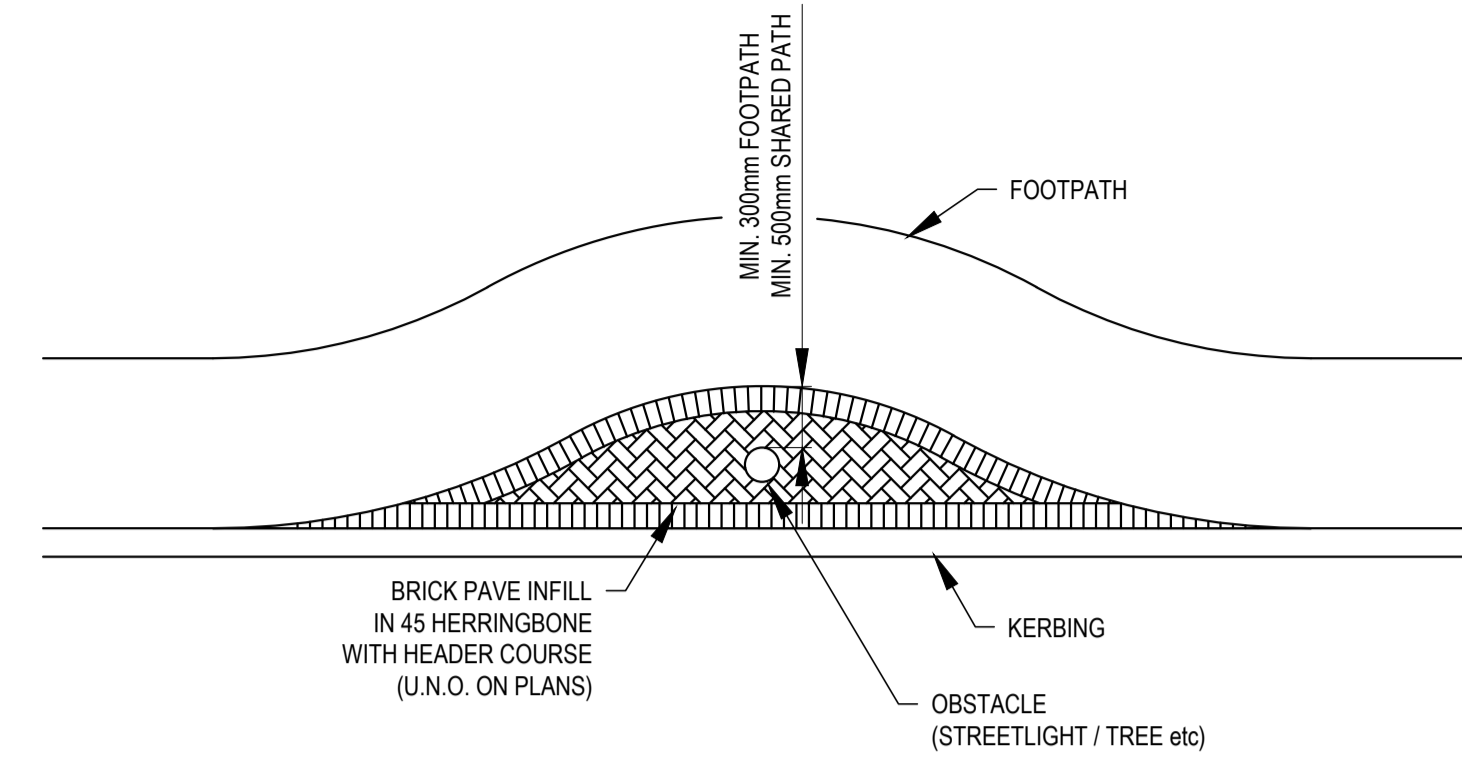

**INFILL AT PATH DIVERSION**  
N.T.S.

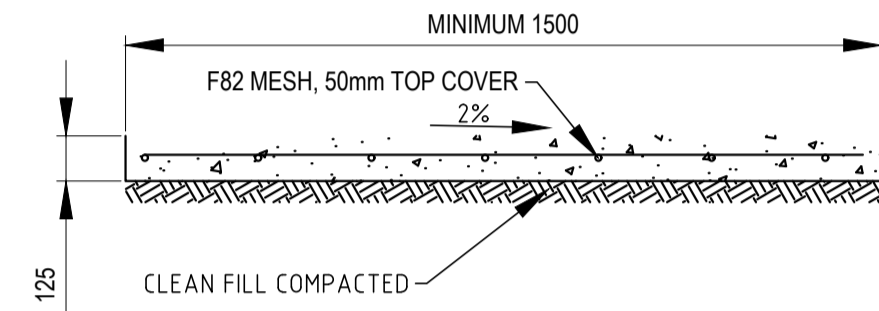

**CONCRETE PATH TYPICAL SECTION – TYPE 3**  
SCALE 1:20 (A1)

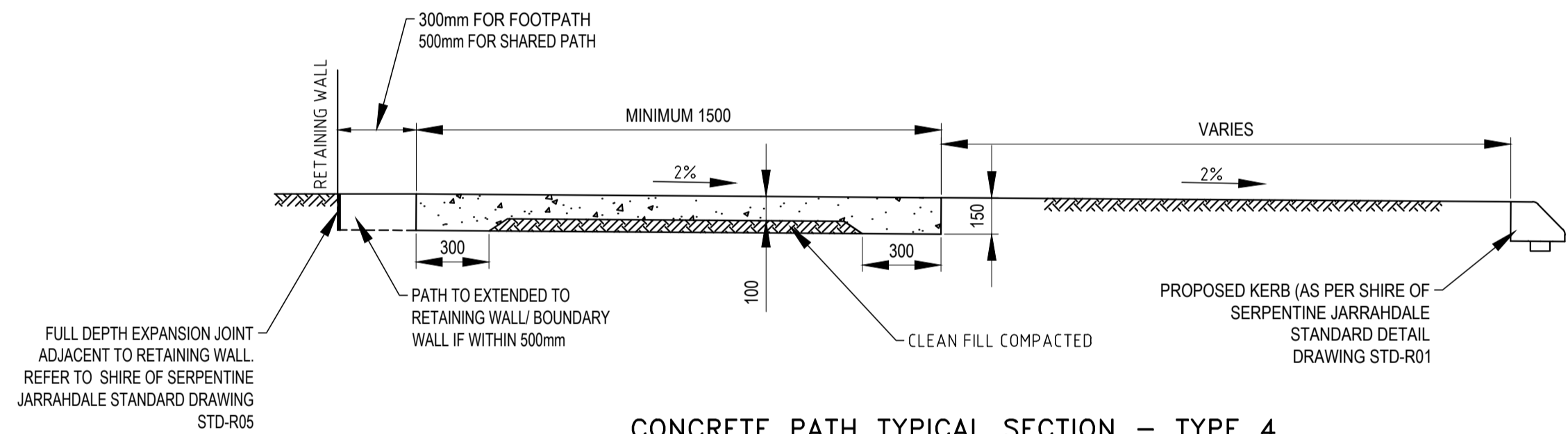

**CONCRETE PATH TYPICAL SECTION – TYPE 4**  
SCALE 1:20 (A1)

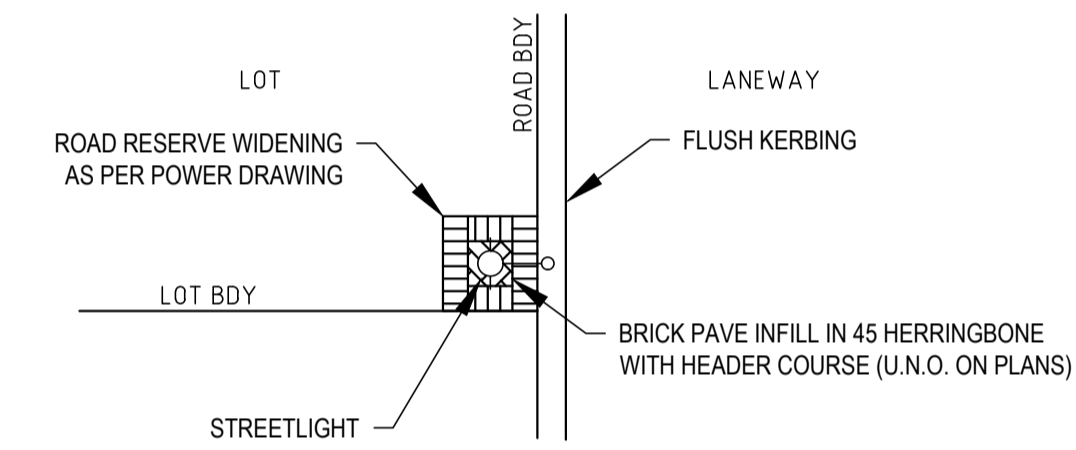

**INFILL AT LANEWAY STREETLIGHTS**  
N.T.S.

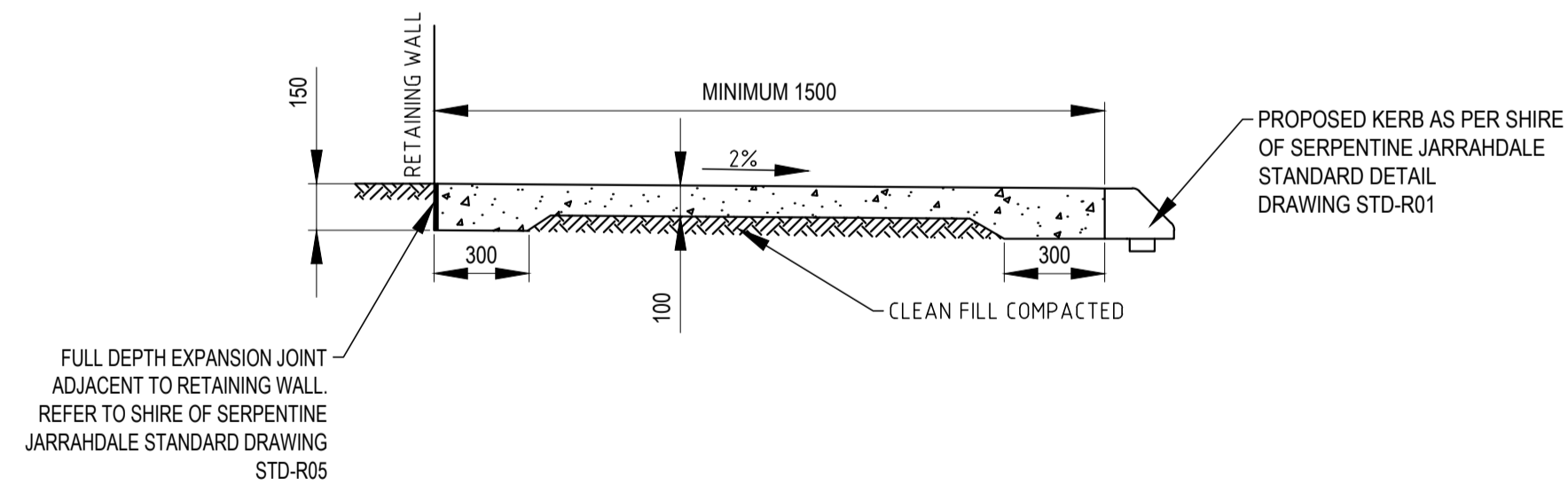

**CONCRETE PATH TYPICAL SECTION – TYPE 5**  
SCALE 1:20 (A1)

**NOTES:**

- FOUNDATION TO BE COMPACTED TO 95% MODIFIED DRY DENSITY.
- ALL CONCRETE FOR FOOTPATH CONSTRUCTION TO BE A MINIMUM OF 25MPa, 20mm AGGREGATE AND A MAXIMUM SLUMP OF 80mm-100mm.
- REINFORCED CONCRETE PATH SHALL BE MINIMUM OF 125mm THICK, 32MPa @ 28 DAYS COMPRESSIVE STRENGTH WITH F82 REINFORCEMENT MESH.
- BEDDING - SAND (100mm MINIMUM).
- EXPANSION JOINTS AS PER SHIRE OF SERPENTINE JARRAHDAL STANDARD DRAWING STD-R05.
- CONTRACTION JOINTS AS PER SHIRE OF SERPENTINE JARRAHDAL STANDARD DRAWING STD-R05.
- SURFACE TO BE BROOM FINISH, NON-SLIP PARALLEL TO KERB LINE, WITH SMOOTH TROWELLED EDGE APPROXIMATELY 75mm WIDE AT EDGES.
- DIMENSIONS IN MILLIMETRES.
- LONGITUDINAL GRADE SHOULD NOT EXCEED 1 IN 20.
- WHERE LONGITUDINAL GRADE IS GREATER THAN 1 IN 14, LANDINGS WILL BE PROVIDED EVERY 6m.
- VERTICAL CLEARANCES ALONG PATHS SHOULD BE A MINIMUM OF 2.4m.
- WHERE STREET FURNITURE (POLES, BENCHES, RUBBISH BINS, POSTS, ETC) ARE LOCATED IN PATH, A MINIMUM UNOBSTRUCTED WIDTH OF 1.2m MUST BE MAINTAINED, PLUS CLEARANCE TO OBSTACLE.
- WHERE COVERS (M/N, TELSTRA, WATER, DRAINAGE, ETC) ARE LOCATED WITHIN PATHS, A MINIMUM CONCRETE EDGE THICKNESS OF 200mm MUST BE PROVIDED AROUND THE COVER, AND EXPANSION JOINTS ARE REQUIRED SURROUNDING THE COVER.

A:\Engineering\Standard Details\DWG\STD-R01 - FOOTPATH DETAILS.dwg

Amendments		Scale	Date	By	Approved
AS SHOWN					
N/A					
No	Date	Revision			
A	30/11/23	ISSUED FOR REVIEW		BV	NS



THIS DRAWING REMAINS THE PROPERTY OF THE SHIRE OF SERPENTINE JARRAHDAL AND SHALL NOT BE RETAINED, COPIED, OR USED, WITHOUT WRITTEN APPROVAL FROM THE DIRECTOR ENGINEERING SERVICES

Drawn:	BC	Date:	30/11/23	Signat:	
Designat:	BV	Date:	30/11/23	Signat:	
Checked:	VB	Date:	30/11/23	Signat:	
Manager Engineering Services:					

SHIRE OF SERPENTINE JARRAHDAL STANDARD DRAWINGS		Sheet No:	1 OF 1
ROAD - FOOTPATH DETAILS		Revision No:	A
		DWG No:	STD-R07