

**PLAN - KERB JOINTING**  
N.T.S.

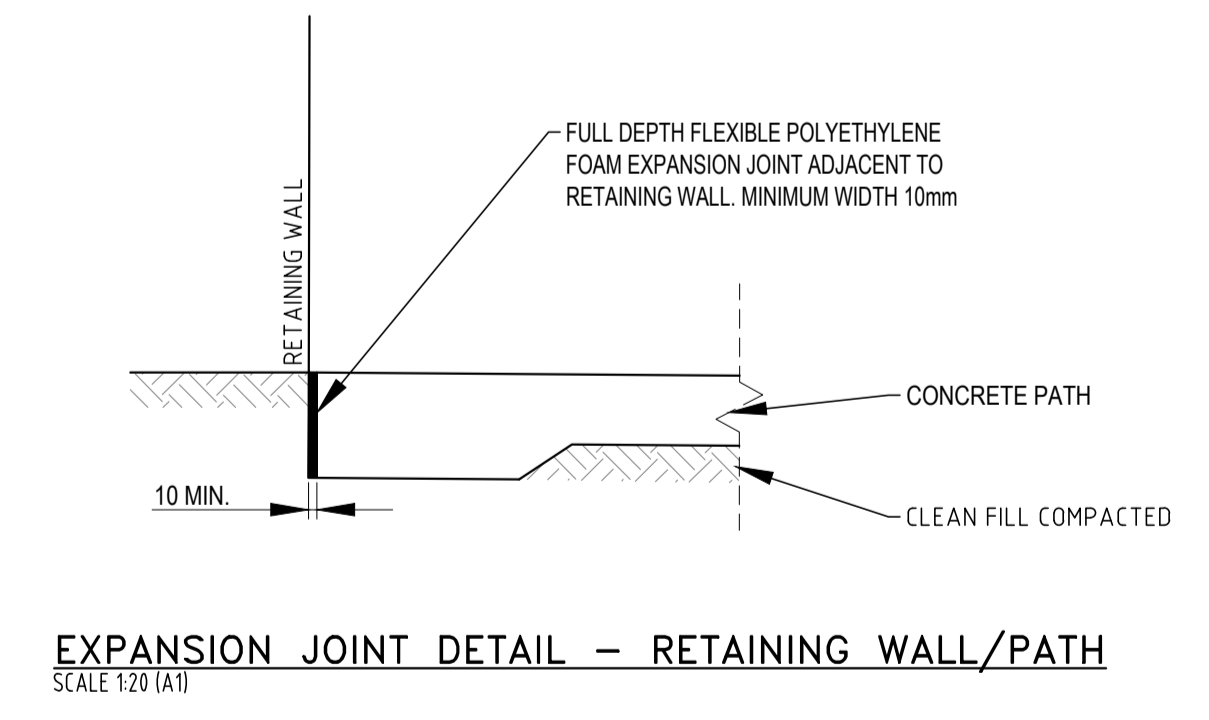
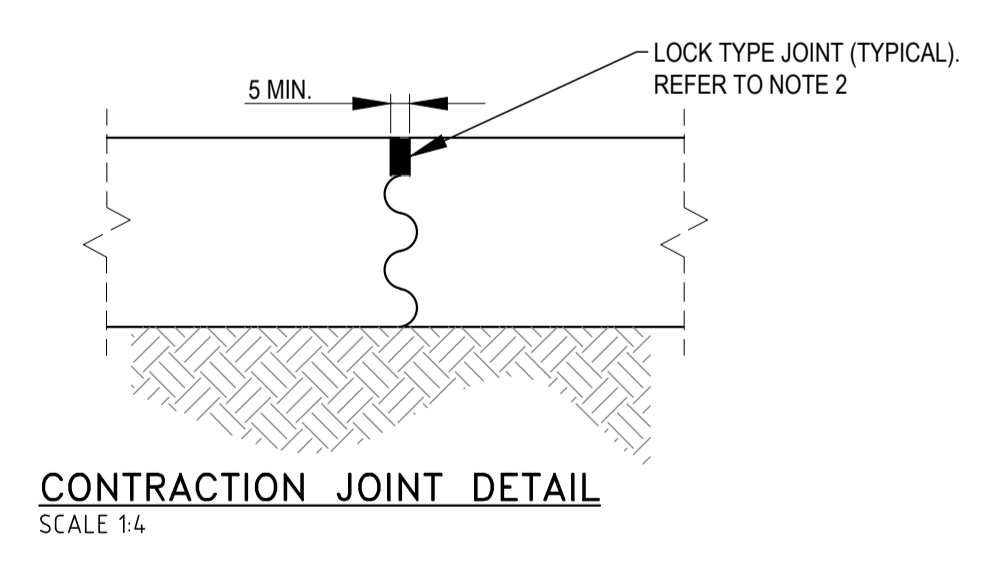
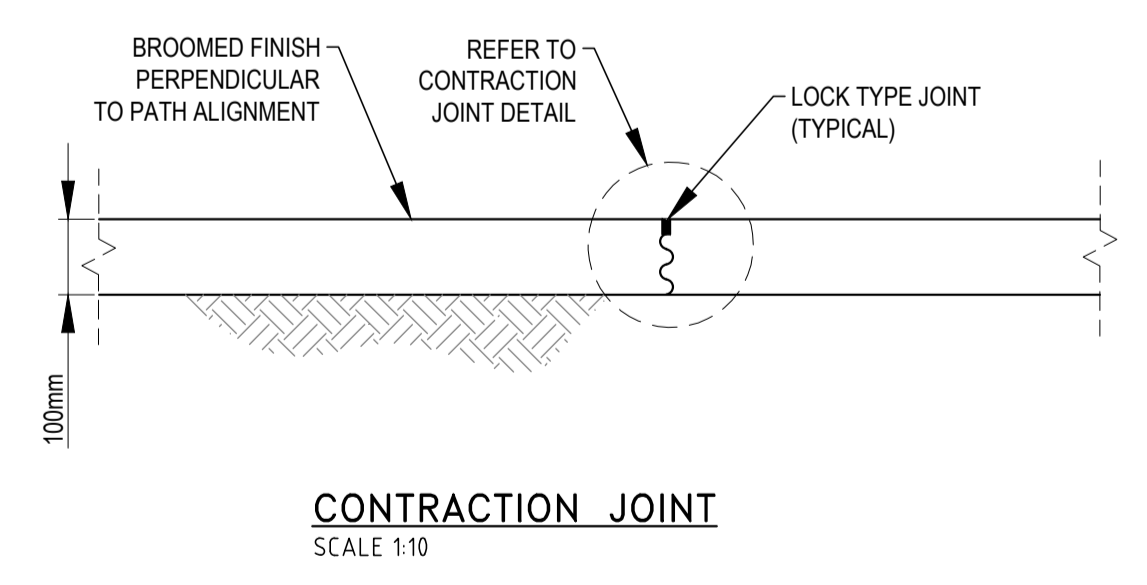
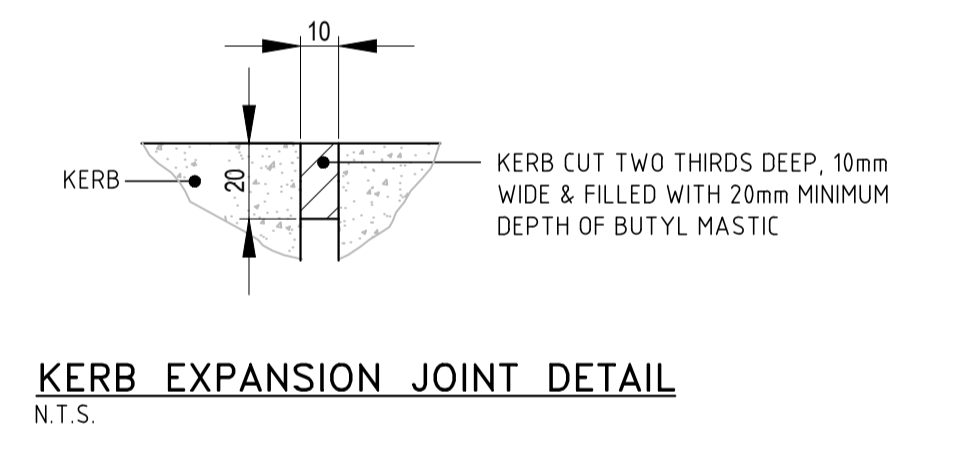
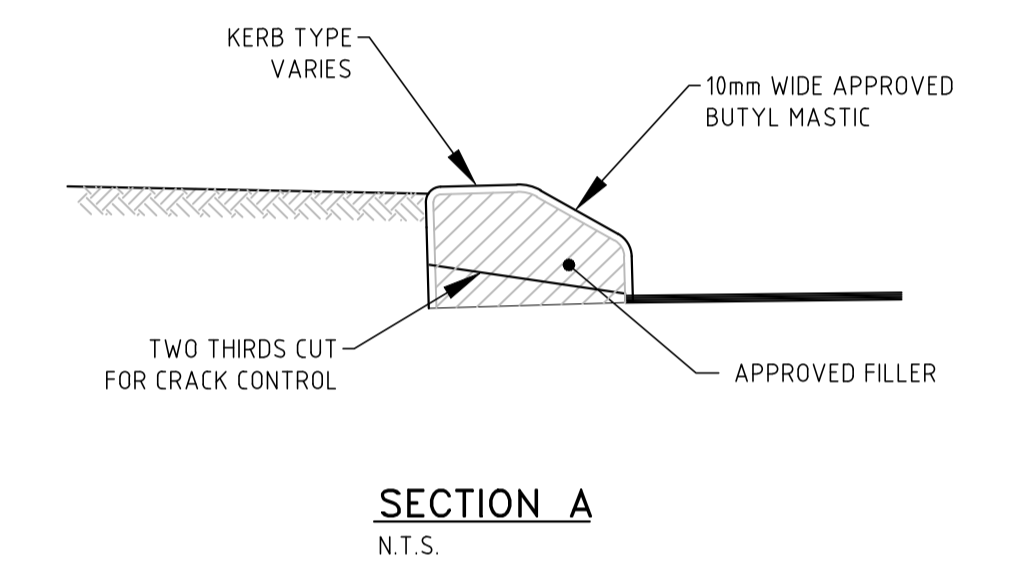
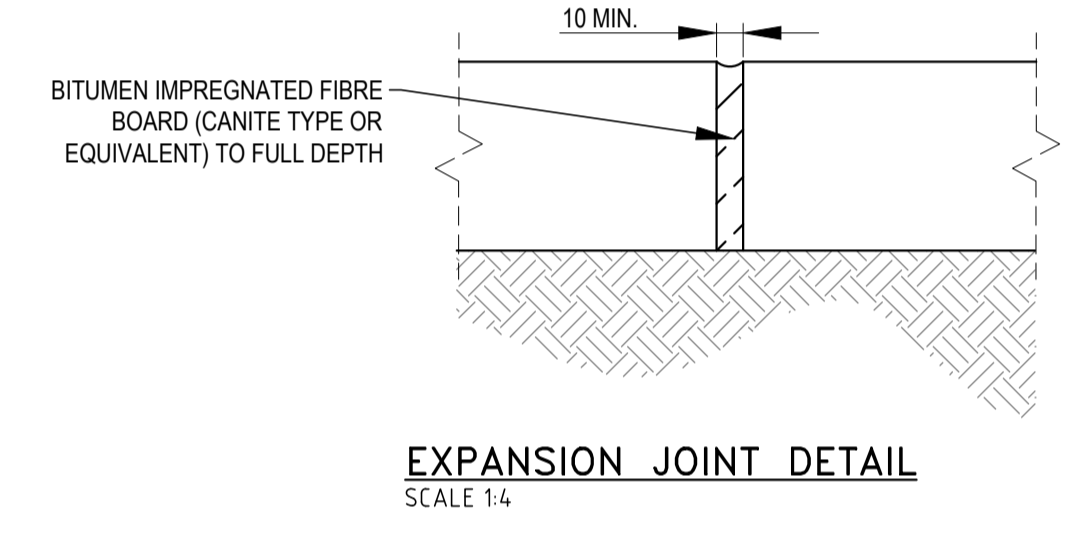
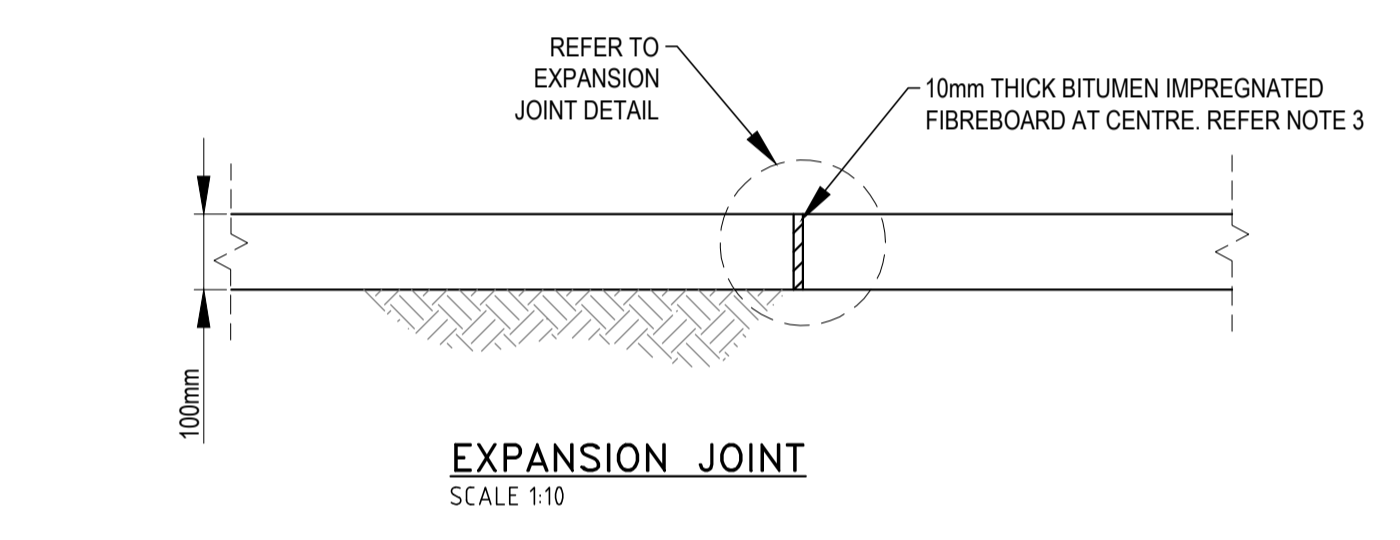

- NOTES:**
- ALL FOOTPATHS TO BE A MINIMUM 1.5m WIDE AND ALL SHARED PATHS TO BE A MINIMUM 2.5m WIDE UNLESS ADVISED OTHERWISE BY THE SHIRE.
  - CONTRACTION JOINTS TO BE LOCK JOINT TYPE OR AS OTHERWISE APPROVED BY THE SHIRE.
  - EXPANSION JOINTS TO BE PLACED AT 10m INTERVALS, TANGENT POINTS, CHANGE OF DIRECTION, END OF DAY WORKS AND AROUND ALL SERVICES AND WHERE THE PATH JOINS KERB RAMPS AND VEHICLE CROSSINGS.
  - CONCRETE TO ACHIEVE A MINIMUM 25MPa COMPRESSIVE STRENGTH AT 28 DAYS. A MINIMUM NOMINAL SIZE AGGREGATE OF 14mm, A MAXIMUM OF 20mm AND A SLUMP OF 75mm.
  - FOOTPATH THICKNESS TO BE 100mm MINIMUM.
  - KERB ALIGNED PATH JOINTS TO MATCH KERB JOINTS.
  - REFER TO SHIRE OF SERPENTINE STANDARD DRAWING NUMBER STD-R07 FOR TYPICAL FOOTPATH DETAILS AND STANDARD DRAWING NUMBER STD-R04 FOR TYPICAL PEDESTRIAN RAMP DETAILS.
  - EXPANSION JOINTS WITHIN FLUSH KERBING TO BE PROVIDED AT 50m INTERVALS. EXPANSION JOINTS ARE TO BE CUT NOT LESS THAN 24 HOURS NOR MORE THAN 72 HOURS AFTER PLACING OF CONCRETE.

A:\Engineering\Standard Details\DWG\STD-R05 - JOINT DETAILS.dwg

Amendments		Scale	Date	By	Approved
		AS SHOWN			
		N/A			
A	30/11/23	ISSUED FOR REVIEW		BV	NS
No	Date	Revision		By	Approved

Shire of Serpentine Jarrardale  
**Infrastructure and Design**

THIS DRAWING REMAINS THE PROPERTY OF THE SHIRE OF SERPENTINE JARRARDALE AND SHALL NOT BE RETAINED, COPIED, OR USED, WITHOUT WRITTEN APPROVAL FROM THE DIRECTOR ENGINEERING SERVICES

Drawn: BC Date: 30/11/23  
Designed: BV Date: 30/11/23  
Checked: VB Date: 30/11/23  
Manager Engineering Services

Project: SHIRE OF SERPENTINE JARRARDALE STANDARD DRAWINGS

Title: ROAD - JOINT DETAILS

Sheet No: 1 OF 1  
Revision No: A  
DWG No: STD-R05